

PLAN SHOWING THE PROPOSED RESIDENTIAL FLATS AT PLOT NO:15, GOLDEN AVENUE VELLACHERY CHENNAI-42, S.NO:373/4 PART 1 CHANNEL VELLACHERY VILAGE C.No. 352/03

Scrutiny Plan / Revised Plan
SPECIFICATIONS:
 WALLS: BRICK BRICKS CM-1.4
 PLASTER: M.F.F. WALLS BY CM-1.4
 RCC: M20 GRADE CONCRETE BY CM-1.4
 IN THIS PROJECT WE ARE FOLLOWING THE SPECIFICATIONS AS PER IS 8153:1973
 SPECIAL CEILING PLASTERING IN CM 1:5, 10MM THICK, WEATHERING COURSE WITH BRICK JELLY CONCRETE, TERRACE FLOORING WITH TWO COURSE OF FLAT TILES, SAND FILLING 15 CM THICK FOR FOUNDATION AND BASEMENT

AREA DETAILS: (S.FT) (S.MT)

GROUND FLOOR	963.33 [89.53]
FIRST FLOOR	1762.12 [163.76]
SECOND FLOOR ABOVE STILT FLOOR	964.17 [89.61]
TOTAL AREA	3689.62 [342.90]
SITE AREA	2720.00 (252.79)
F.S.I	1.34
PLOT COVERAGE	64.74%

SCHEDULE OF JOINERY

MD - MAIN DOOR	- 3'3"x7'0" (1.0X2.13)
FD - FRENCH DOOR	- 6'0"x7'0" (1.82X2.13)
D - DOOR	- 3'0"x7'0" (0.91X2.13)
D1 - DOOR	- 2'6"x7'0" (0.76X2.13)
W - WINDOW	- 6'0"x4'6" (1.83X1.37)
W1 - WINDOW	- 4'0"x4'6" (1.22X1.37)
KW - KITCHEN WINDOW	- 4'0"x3'6" (1.22X1.07)
V - VENTILATOR	- 2'0"x2'0" (0.61X0.61)

COLOUR INDEX:

PROPOSED BUILDING	
EXISTING ROAD	
SITE BOUNDARY LINE	

SCALE : 1"=8'0" DATE : 27-07-2003

DRAWN BY : *A. Pathya* CHKD. BY :

OWNER:

LICENSED SURVEYOR:

G. Ramesh Sathya
G. RAJESH KRISHNAN, B.E.,
 Civil & Structural Design Engineer,
 Class-I Licensed Surveyor No: 773
 Corporation of Chennai
 Expert in Vasthu Sastra & Prediction
 Civil Engineering Consultants & Contractors
 New No: 76, Alandur Road, Sakthepet, Chennai-600048
 Cell Phone: 9444140151

D:\RAMESH\SATHYA\OTHERS\PANNER\CORP.dwg

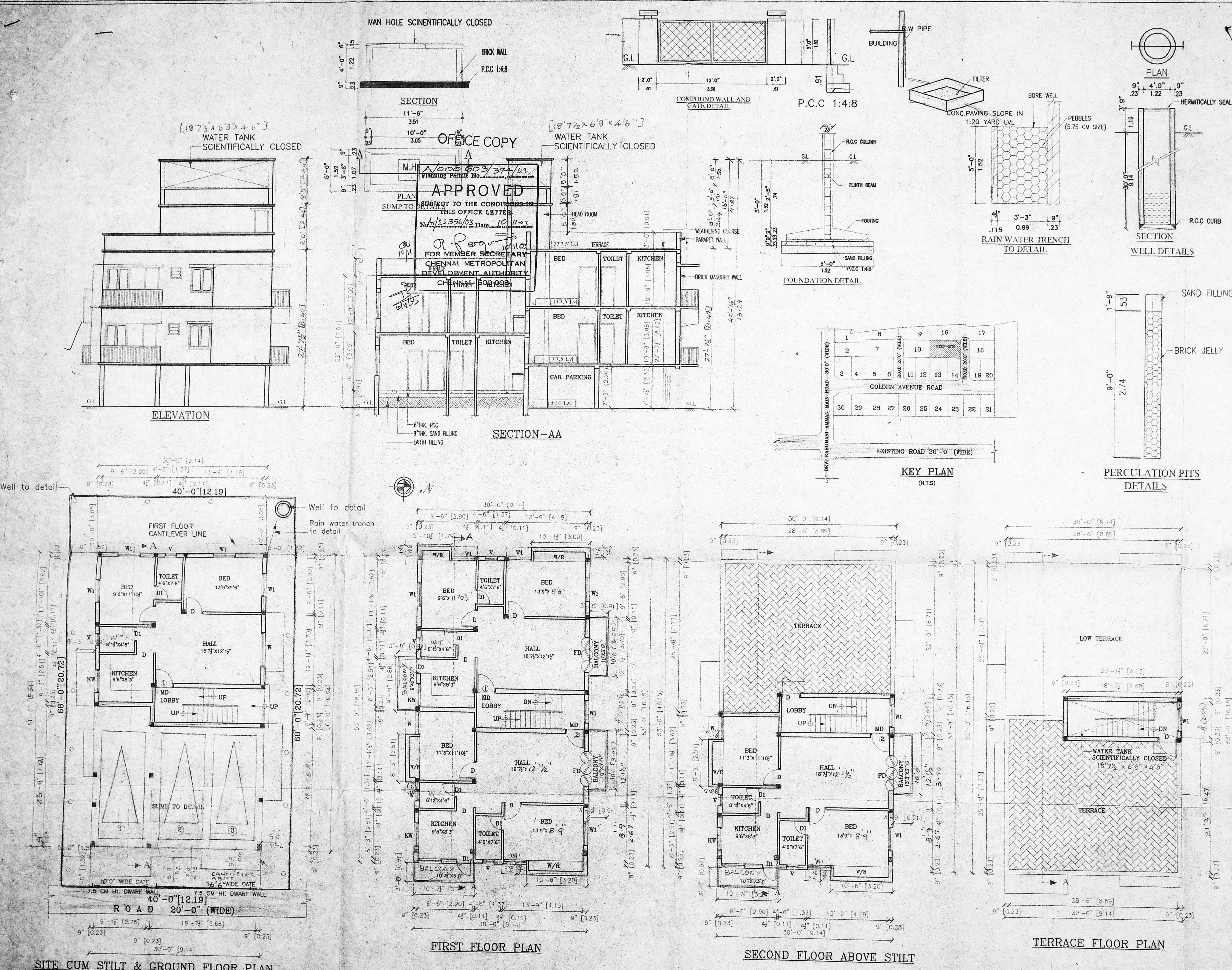

SITE CUM STILT & GROUND FLOOR PLAN

FIRST FLOOR PLAN

SECOND FLOOR ABOVE STILT

TERRACE FLOOR PLAN